

Fenercioglu (Developer) + Aqua Country (Complex)

### Aqua Country residential complex

Location **Kyrenia, Bahçeli**



### About the project



Developer	<b>Fenercioglu</b>	
Start of sale	<b>01.11.2023</b>	
Key handover	<b>2025</b>	
Houses/blocks	<b>2</b>	
Building floor	<b>2</b> Min	<b>2</b> Max
Units total	<b>40 - 1+1</b>	

Distance to the sea - 600 m  
 Distance to key locations:  
 Airport 45 min, Supermarket 7 min, Pharmacy 10 min, School 13 min, Kindergarten 12 min, Hospital 11 min.

The Aqua Country residential complex is an exclusive offer for those seeking comfort and privacy in the picturesque area of Bahçeli, just 600 meters from the Mediterranean coast in Northern Cyprus. Consisting of 4 modern buildings, this residential complex promises a comfortable and stylish lifestyle, combining modern architecture with the natural beauty of the region. Inside the residential complex, on an area of 5927 square meters, there are 32 spacious apartments, including two-level lofts and penthouses. The modern architectural style, panoramic glazed windows and terraces with views of nature make each apartment a special place to live.

### Complex infrastructure

- Bar
- Fitness centr.
- Kid's playground
- Open pool
- Parking
- Sauna

### Available units 26 / 40 total

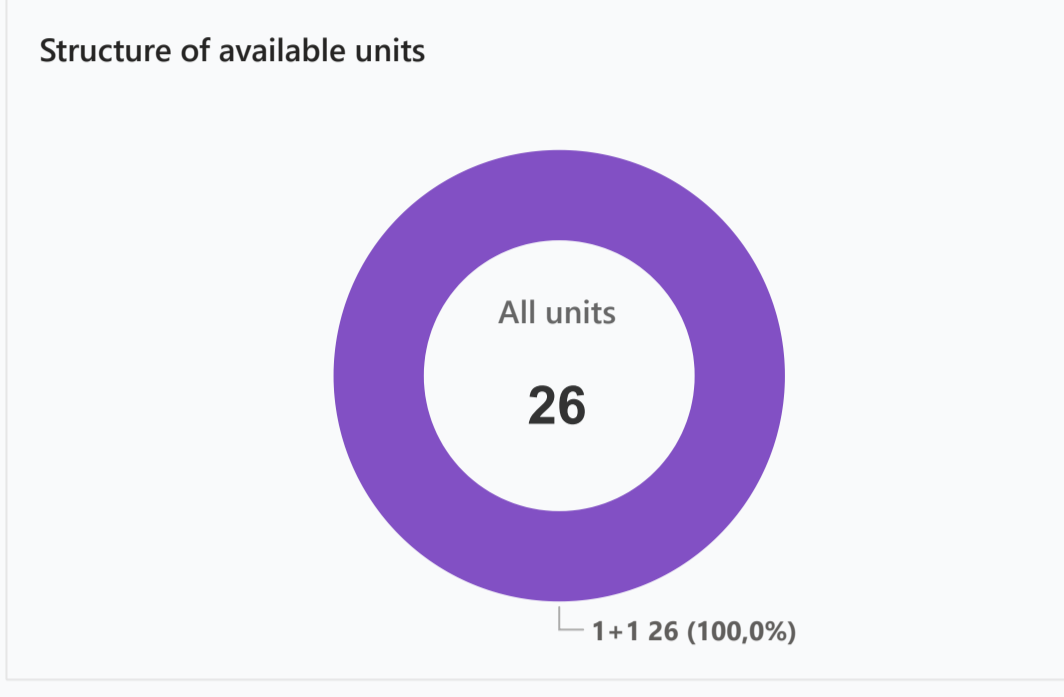
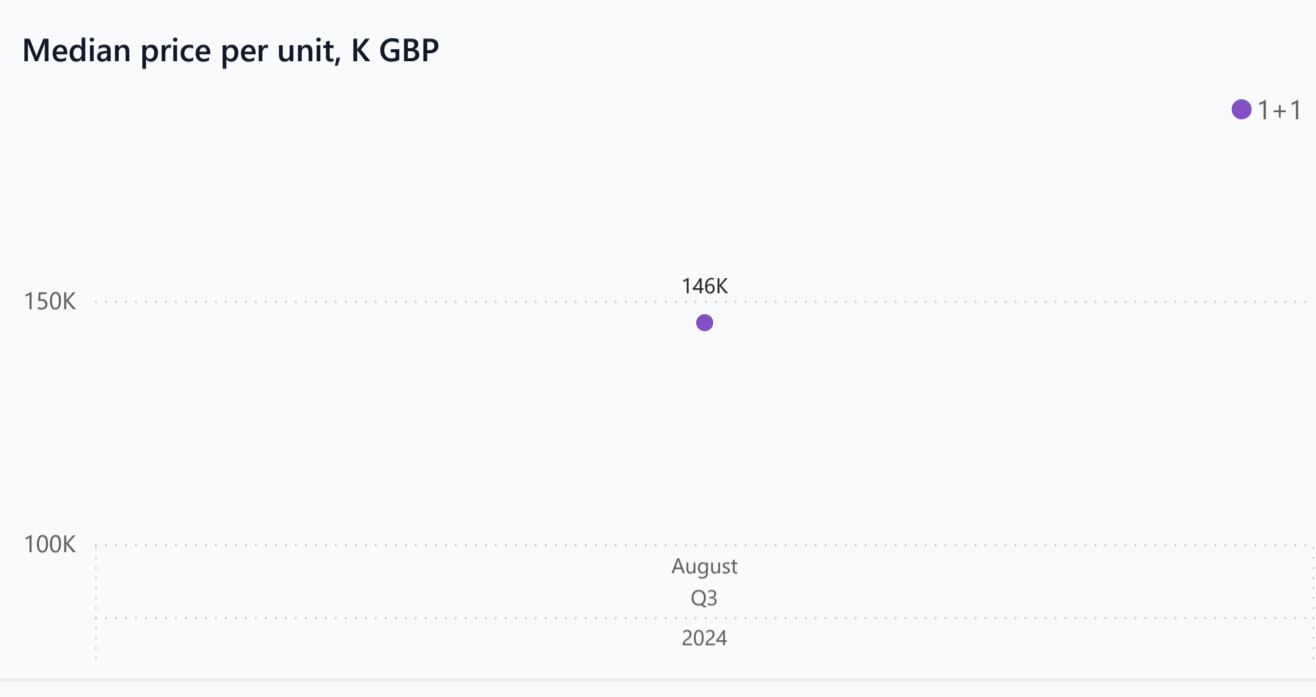

### Plans



### Payment plans

Deposit (non-refundable) NET

Option 1	Option 2	Option 3	Option 4
<input checked="" type="radio"/> Down payment <b>35 %</b>	<input checked="" type="radio"/> Down payment -	<input checked="" type="radio"/> Down payment -	<input checked="" type="radio"/> Down payment -
Installments months <b>18</b>	Installments months -	Installments months -	Installments months -
Discount -	Discount -	Discount -	Discount -
Offer -	Offer -	Offer -	Offer -

Special offer: Fully furnished design package

Rental guarantee

Trafo (Blank) GBP Resale - Maintenance fee - Rental services -

### Details

Bedrooms	Subtype	Block	Unit №	Floor	View	Bathroom	Internal area, sq. m	Balcony/ Terrace, sq. m	Rooftop terrace, sq. m	Garden, sq. m	Gross covered area, sq. m	Current price, GBP	Price per sqm, GBP
1+1	Loft	A	3	0		2					85	145 500	1 712
1+1	Loft	A	4	0		2					85	145 500	1 712
1+1	Loft	A	7	0		2					85	145 500	1 712
1+1	Loft	A	8	0		2					85	148 500	1 747
1+1	Loft	A	9	0		2					85	148 500	1 747
1+1	Loft	A	6	0		2					85	149 500	1 759
1+1	Loft	A	10	0		2					85	151 500	1 782
1+1	Flat	A	13	01							88	139 500	1 585
1+1	Flat	A	14	01							88	139 500	1 585
1+1	Flat	A	18	01							88	139 500	1 585
1+1	Flat	A	15	01							88	142 500	1 619
1+1	Flat	A	11	01							88	145 500	1 653
1+1	Flat	A	20	01							88	145 500	1 653
1+1	Loft	B	2	0		2					85	145 500	1 712
1+1	Loft	B	3	0		2					85	145 500	1 712
1+1	Loft	B	4	0		2					85	145 500	1 712
1+1	Loft	B	7	0		2					85	145 500	1 712
1+1	Loft	B	5	0		2					85	149 500	1 759
1+1	Loft	B	6	0		2					85	149 500	1 759
1+1	Loft	B	10	0		2					85	158 500	1 865
1+1	Flat	B	13	01							88	139 500	1 585
1+1	Flat	B	14	01							88	139 500	1 585
1+1	Flat	B	15	01							88	141 500	1 608
1+1	Flat	B	16	01							88	142 500	1 619
1+1	Flat	B	11	01							88	145 500	1 653

### Interior specification



- Ceramic flooring
- Double glazed windows
- Laminate flooring in the bedrooms
- Steel ladder with wood step
- Toilet integrated in the walls

### Exterior specification

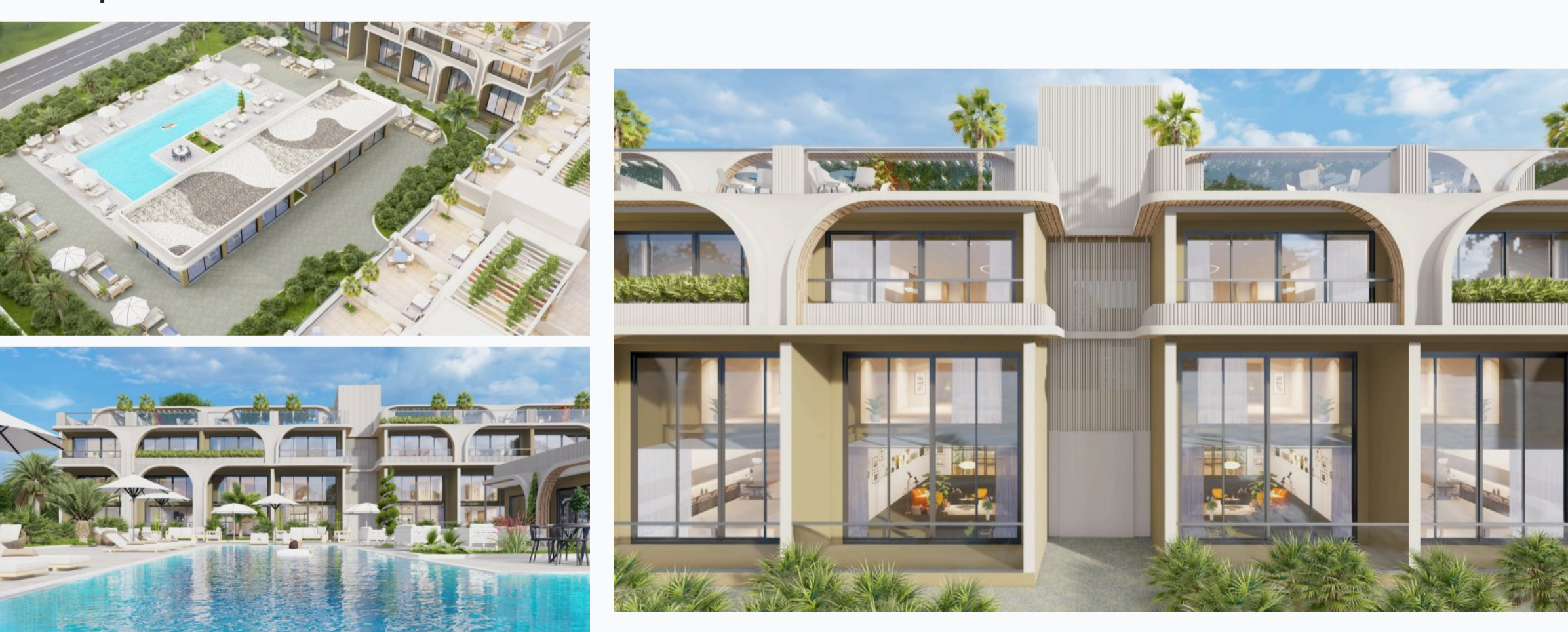

- Glass fence balcony
- Terracing wit. inbuilt lighting & power sockets

### Location of complex

